

NOTES

- Grid shown is based on New Hampshire coordinate system.
- Maps to be used for assessing purposes only. Not for legal conveyance of property or deed descriptions.
- Property data and town boundaries compiled from USGS grids, USFS maps, surveys, deed research, aerial photography, & field measurement.
- Parcel areas obtained from either legal surveys or planimetry.

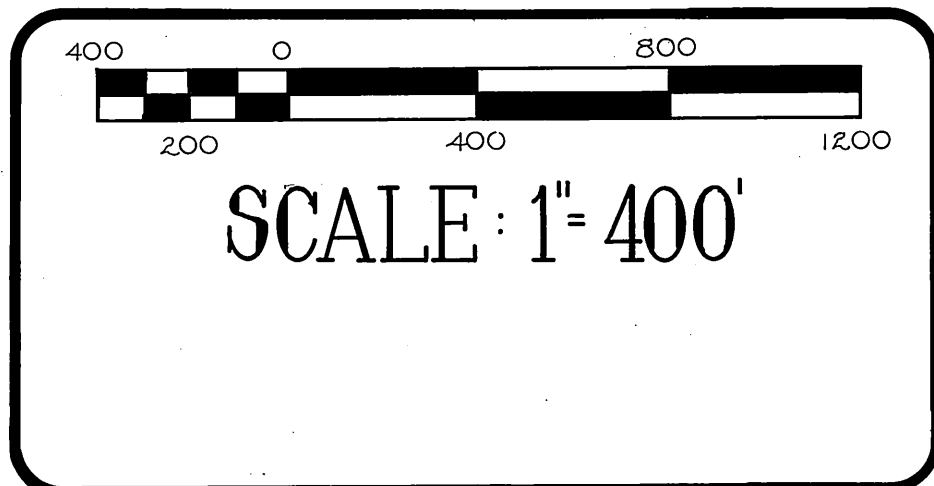

TAX MAP OF THE TOWN OF

RUMNEY

Grafton County, N.H. CURRENT TO: APRIL 1, 2015

LEGEND

- White Mountain National Forest
- stream or brook
- refer to adjacent section map
- gravel road

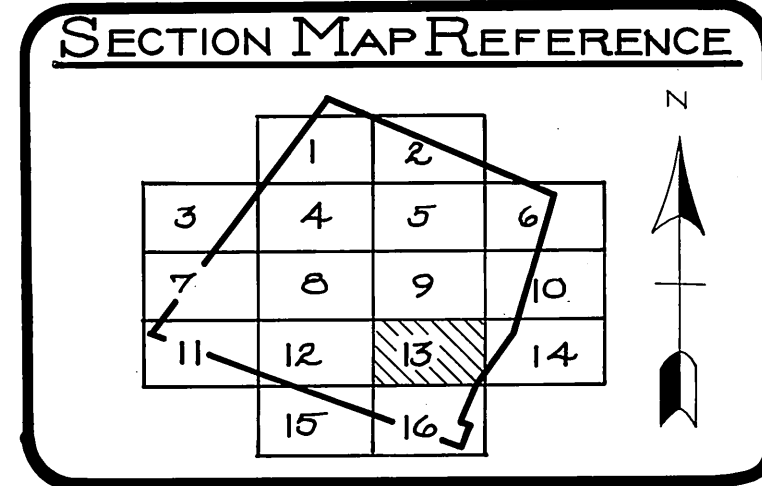

PREPARED BY:

R.R.D. # 1
Campton, N.H.
05223