

**NOTES**

- Grid shown is based on New Hampshire coordinate system.
- Maps to be used for assessing purposes only. Not for legal conveyance of property or deed descriptions.
- Property data and town boundaries compiled from USGS grids, USFS maps, surveys, deed research, aerial photography, & field measurement.
- Parcel areas obtained from either legal surveys or planimetry.

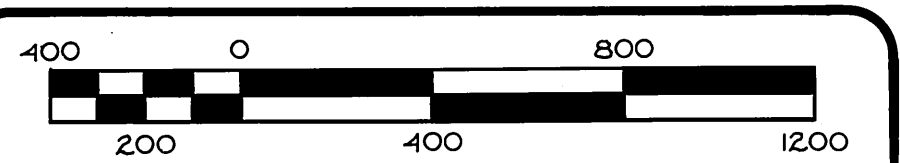

SCALE: 1"=400'

TAX MAP OF THE TOWN OF

**RUMNEY**  
Grafton County, N.H. CURRENT TO: APRIL 1, 2015

**LEGEND**

- White Mountain National Forest
- stream or brook
- refer to adjacent section map
- gravel road

**SECTION MAP REFERENCE**

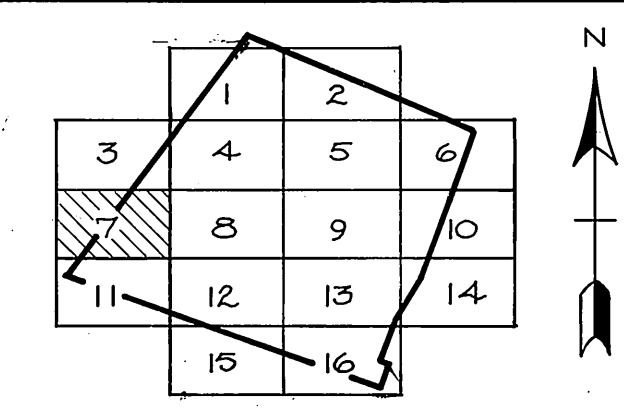

PREPARED BY:

